

ADULT SUNDAY LIFEGROUPS

AT FIRST BAPTIST CHURCH FORNEY

8:00 A.M.

ROOM	GROUP	LEADER
A 109	Median Women	Dian Wade
A 106	Median Couples and Singles	Tim Taylor
A 103-104	Senior Couples and Singles	Dan Warner
A 101-102	Senior Couples and Singles	Frank Schaefer
A 112	Senior Couples and Singles	Randy Newberry
B 002/Chapel	Senior Couples and Singles	Charles Treadway
A 111	Senior Women	Lauri Bordelon
A 107	Men	Jim McConnell

9:15 A.M.

ROOM	GROUP	LEADER
D 072	College and Career (18-24)	James Townsend
A 111	Adult Singles 25+	Dale Bryant
A 103-104	Young Couples w/wo Kids	Addison McElveen
D 232	Young Couples w/wo Kids	Jon Appleton
D 212	Young Families with Kids	Aaron Shedd
D 205	Young Families with Kids	Mark Kuban
D 206	Young Families with Kids	Derek Parker
A 106	Median Families with Students	Blake Eastep
D 214	Young Families of Children with Special Needs	Jason Gradt
A 114	Median Adults	Ed Hale & Darrel Chelette
D 208-209	Median Families with Students	Chad Johnson
D 068	Median Families with Students	Steve Kimbrough
D 210-211	Median Couples and Singles	Jon Foster
D 070	Median Couples and Singles	Gene Hunt
A 101-102	Median Couples and Singles	Lane King
A 115	Median Women	Emily Perdue
D 213	International Couples and Singles	Bill Holley

11:00 A.M.

ROOM	GROUP	LEADER
D 208-209	College and Career (18-24)	Robert Dobbs
A 105	Young Couples w/wo Kids	Mike Middlebrooks
D 068	Young Adults	Joe Hawthorne
D 207	Young Families with Kids	Jeremy Wade
D 231	Young Couples w/wo Kids	Taylor Ainsworth and Mitch Barton
A 107	Median Couples and Singles	Bill Jones
A 110	Median Couples and Singles	Warren Lynch
D 072	Median Families with Students	Brad Davis
D 230	Median Couples and Singles	Michael Idemudia
A 101-102	Senior Couples and Singles	Ken Morrill
A 103-104	Median Couples and Singles	Henry Heredia
A 112	Senior Couples and Singles	Gene Walker
A 113	Median Couples and Singles	Rod Cushing & Will Owens

Young: approx. age 20s - 30s

Median: approx. age 40s - 60s

January 30, 2025 2:41 PM

Map of Building

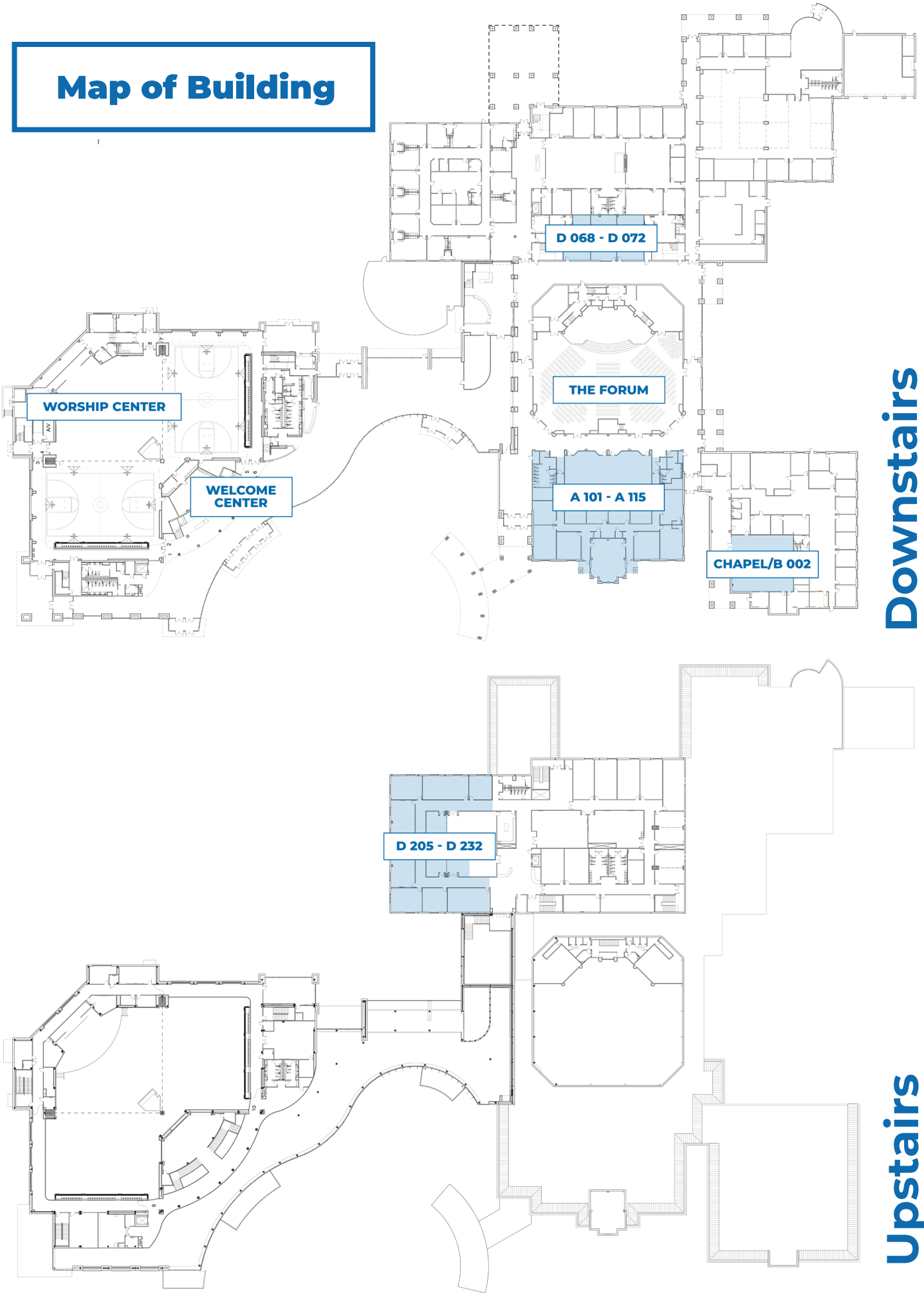

Downstairs

Upstairs